

CENTURION
GARAGE DOORS®

QLD, NSW, VIC

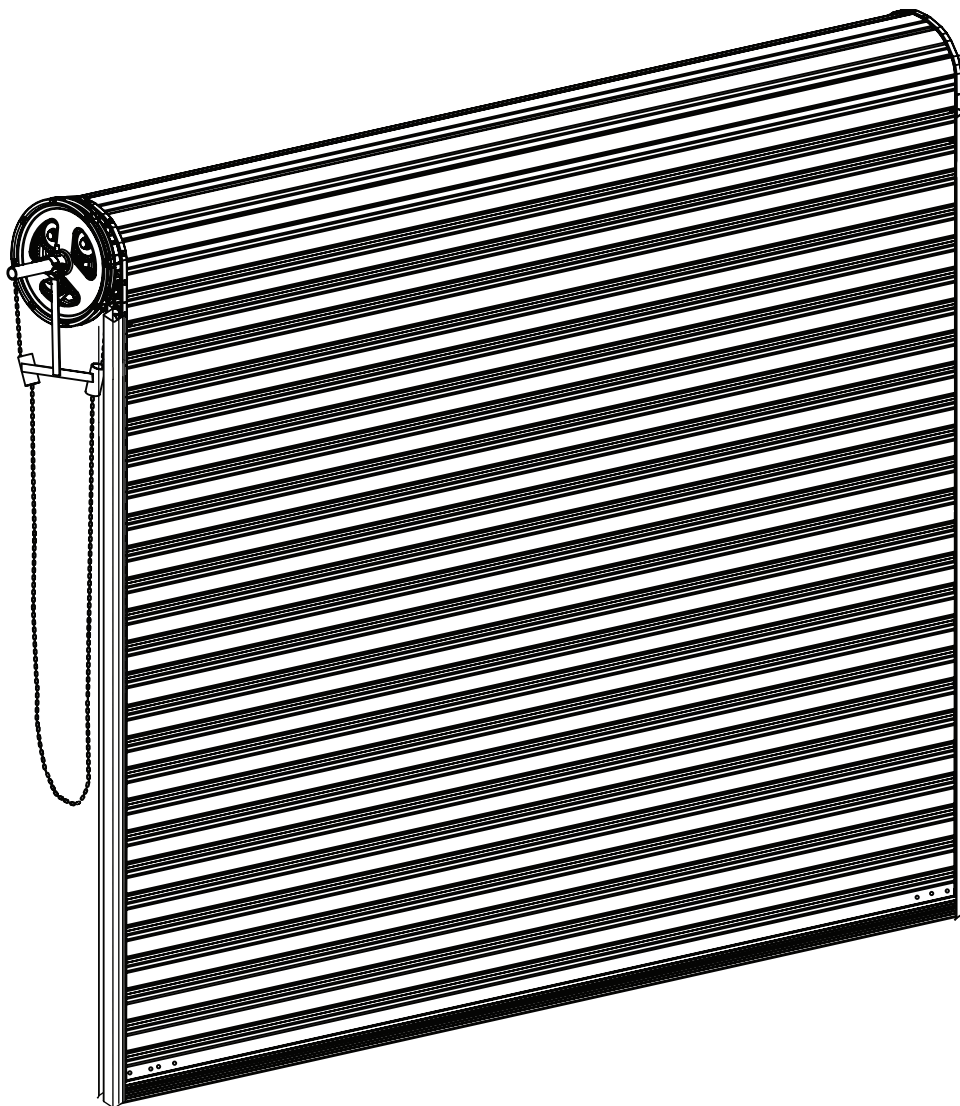

“B” SERIES ROLLER DOOR
Installation Instructions

Revision B - July 2018

**This install is to only be carried out
by a suitably trained industry professional**

WWW.CGDOORS.COM.AU



WARNING



Failure to install this product according to manufacturer's recommendations may result in property damage or serious personal injury. Centurion Garage Doors will not be held responsible for personal injury or product defects if the door is not installed as instructed.

SAFETY CHECKLIST

Do not install this product unless you have read and understood the following safety checklist. All items listed below must be checked and correctly implemented.

1. Prior to commencing work complete a formal risk assessment and tidy up the work site ensuring the work area is clear and safe
2. Apply correct lifting technique. Do not twist when lifting heavy loads. Bend knees and ensure back is kept straight
3. Ensure all all people are kept clear of installers work area with appropriate signage
4. Wear appropriate PPE (boots, safety glasses, ear plugs, gloves etc)
5. Keep hands clear of all sharp edges and potential pinch points
6. Ensure that flammable liquids or materials are removed from the area of work
7. While working at heights ensure a ladder is used correctly and checked before usage. Do not stand on top rung
8. Ensure all electrical connections are kept clear from liquids/moisture. Cords must be kept away from oil, heat and sharp edges
9. Ensure door is correctly secured when applying tension
10. Ensure stilsons are used as per instructed and hands are kept clear of the stilsons at all times
11. Ensure people do not walk under door when when door assembly is suspended onto brackets
12. Tighten Cast Iron Saddles adequately when fixing door assembly to brackets. Ensure not to over tighten as saddles may distort

Parts List

Large Components B Series

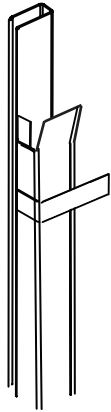

1 Pair 50mm "B" Series Guide



1 x Roller Door Accessory Box



1 x Assembled Roller Door

Additional Components

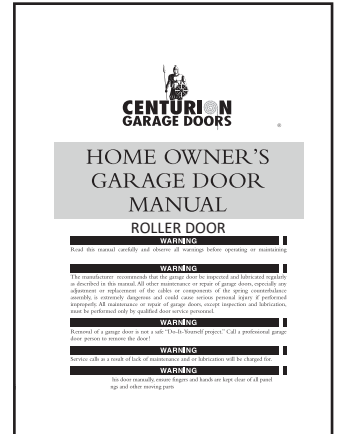

1x Roller Door Manual

Core Components B Series

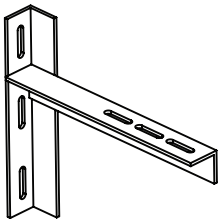

1 Pair "B" Roller Door Bracket
CEN105/106

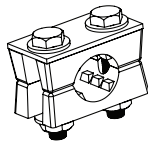

2x Cast Iron Saddle
RP001



1x Planetary Gear set
RDACCB4251P

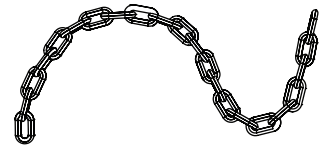

1x Hand Chain

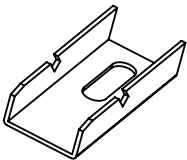

6x AA Series Guide Clips
RGC08401



1x Anti-Coning Clip

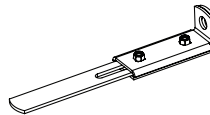

2x Shoot Bolt Lock

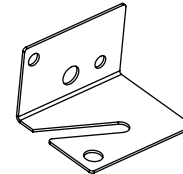

1x Roller Door Chain Lock

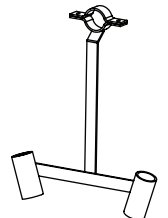

1x Chain Guide

Fasteners B Series

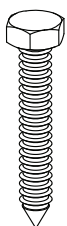

M8 - 70mm Hex Screw
12x

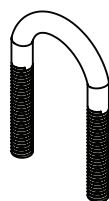

3/8 - Colour Zinc U Bolt
2x



8.2mm ID - Washer
16x



3/8 - Washer
4x

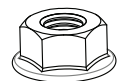

3/8 - Hex Flange Nut
4x

STEP 1 Establish Horizontal Datum

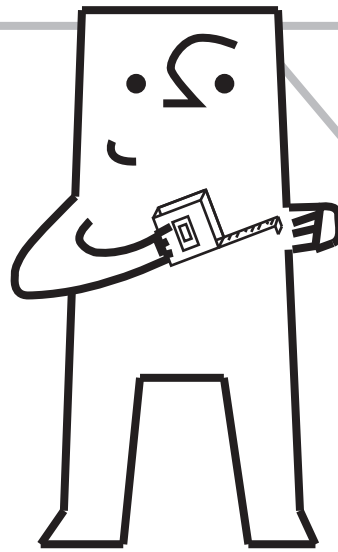
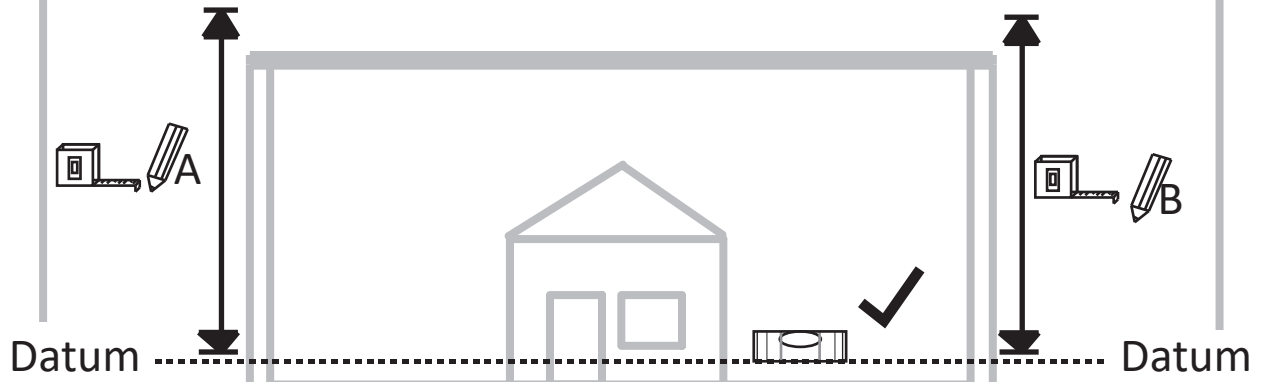

Record Measurements

LHS

Datum to Bracket = mm

RHS

Datum to Bracket = mm



Check Door Size Is Suitable For Opening

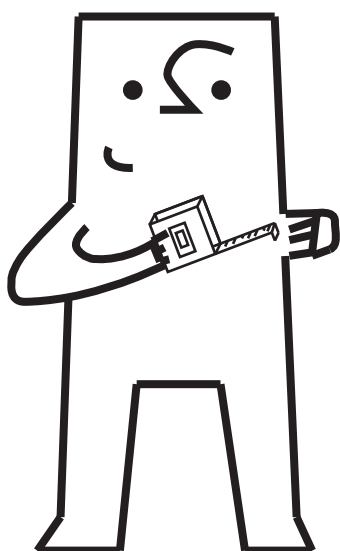
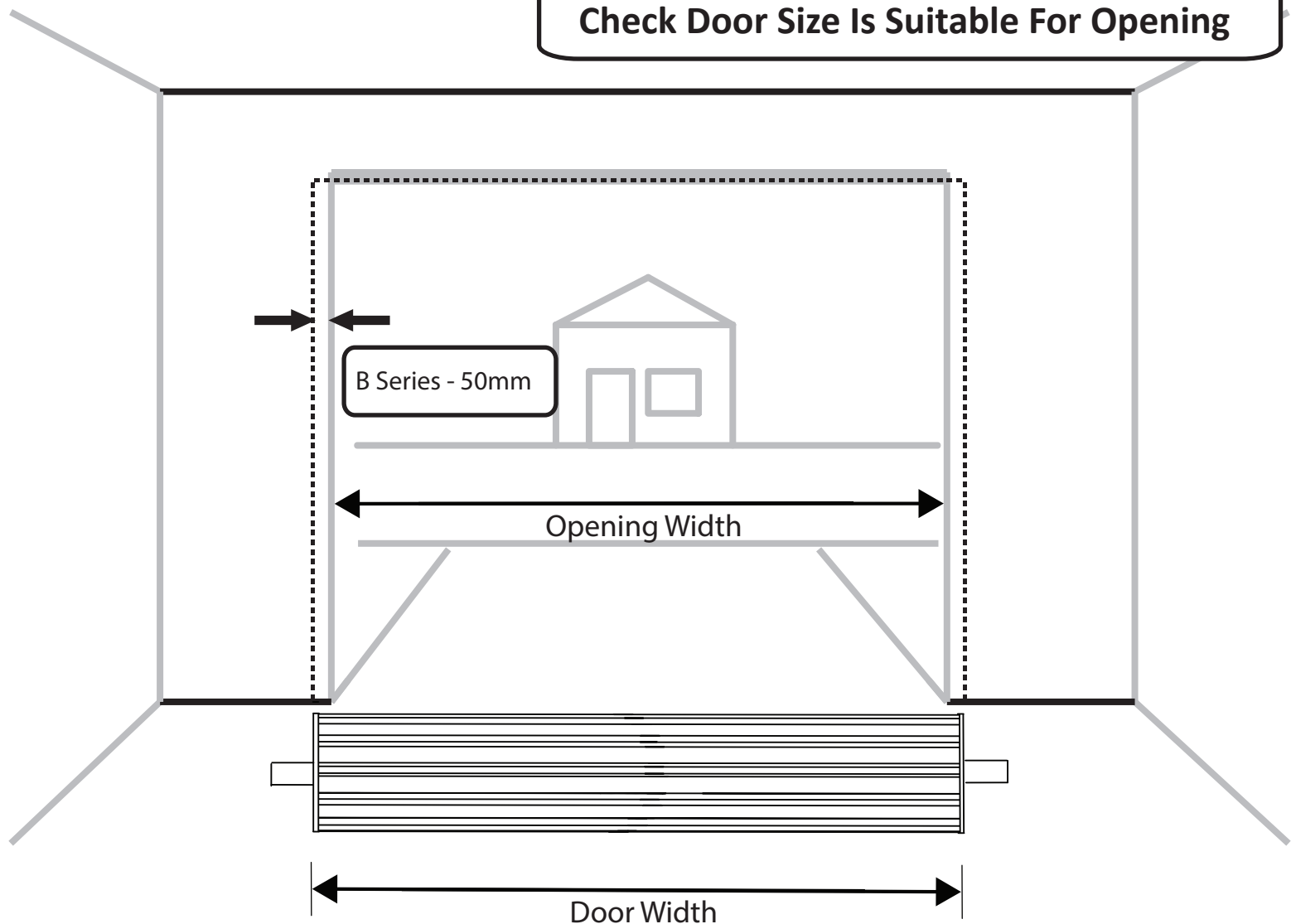

Confirm Correct Door Size

B Series

Door Width = Opening Width + 100mm



STEP 2 Install Mounting Brackets

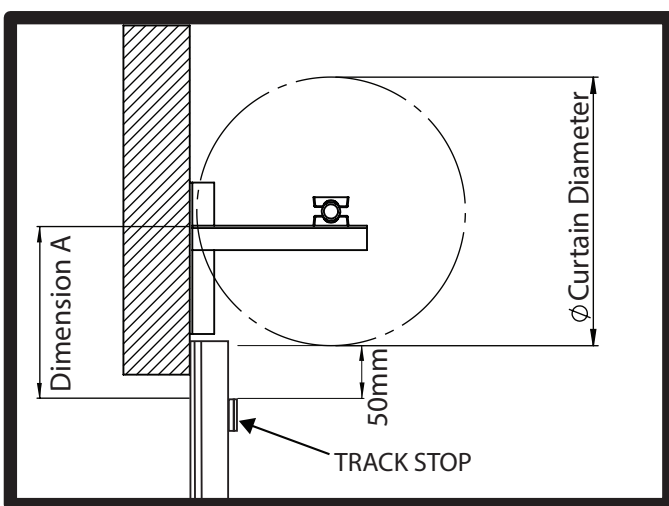
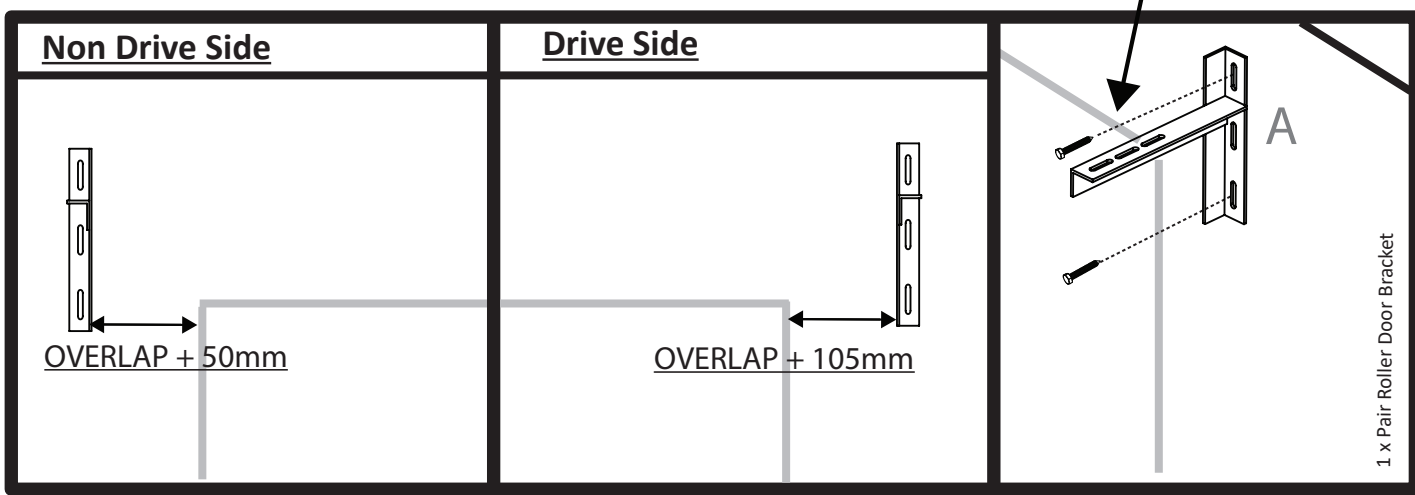
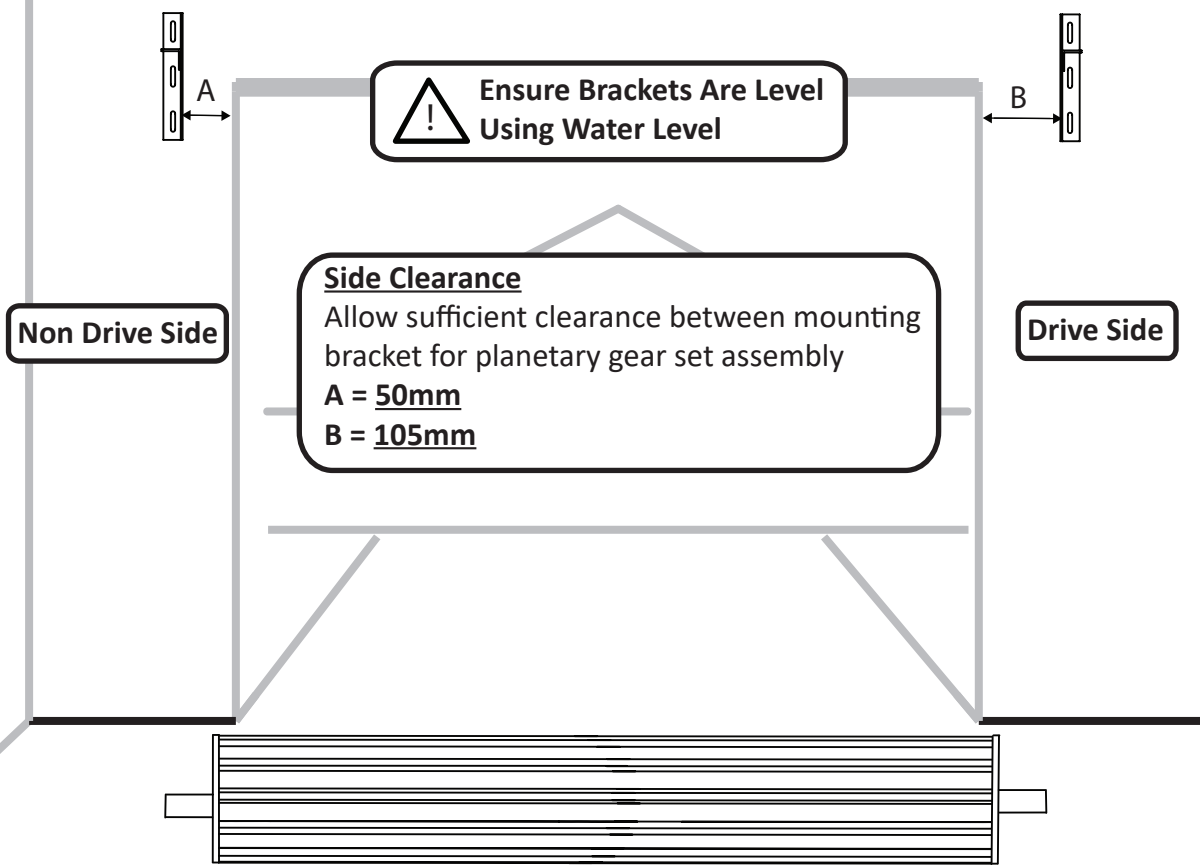

BRACKET POSITION		
DOOR HEIGHT (mm)	CURTAIN DIAMETER (mm)	DIMENSION A (mm)
3000 - 3600	470	190
3601 - 4200	470	255
4201 - 4800	520	285
4801 - 5100	560	305

STEP 3 Centralise Shaft And Fit Planetary Gear Set

1. Centralise Shaft
Rotate axle one turn by hand
and release to centralise shaft

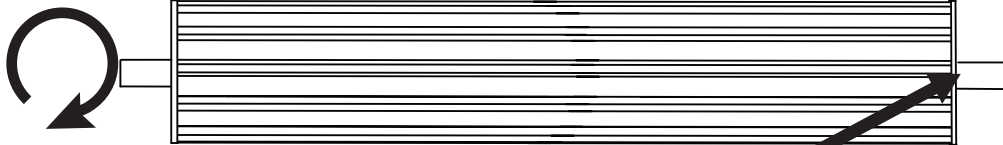

**2. Wipe grease and fit anti-coning clip
to NON-DRIVE SIDE. Ensure clip is fitted
securely on shaft against drum wheel**

Anti-Coning Clip

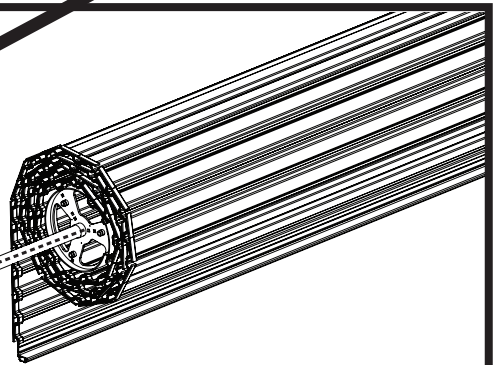

**3. Fit planetary gear set and
chain guide to roller door axle.**



Ensure planetary gear set is fitted
on the pre determined DRIVE SIDE

**4. Drill 10mm hole and bolt
planetary gear set to shaft**

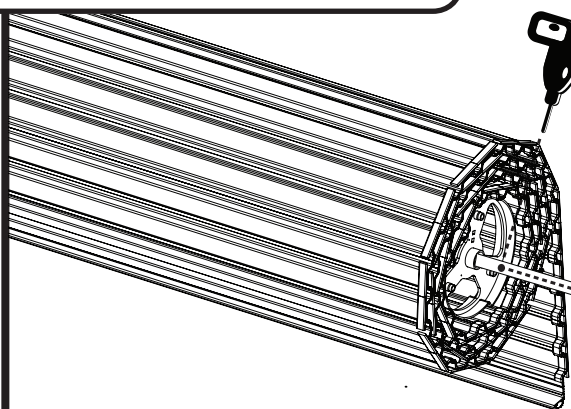

Planetary Gear Kit

Chain Guide

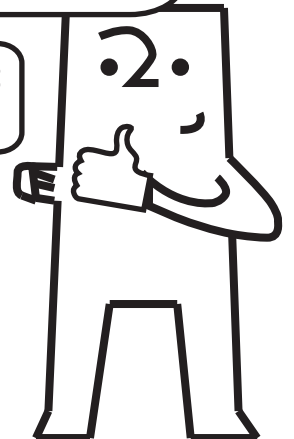

STEP 4 Lift Door and Fit Chain

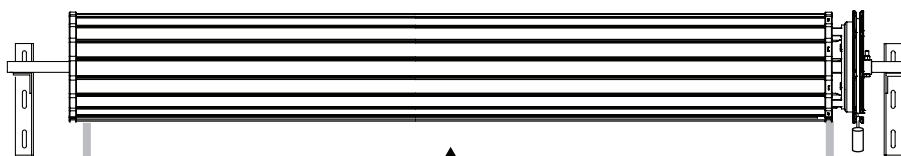

1. Lift Door assembly onto brackets

2. Place shaft onto saddles and secure with supplied fixings

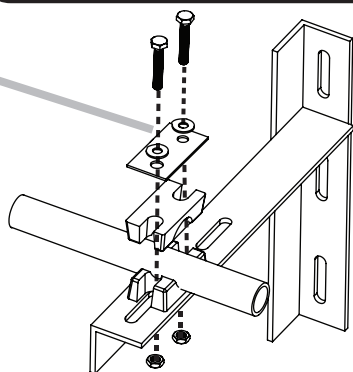

Position saddle over rear slots

LOOSE FIT ONLY



4. Fit chain by running through chain drive wheel.



Ensure there is no twist in chain at engagement with chain wheel

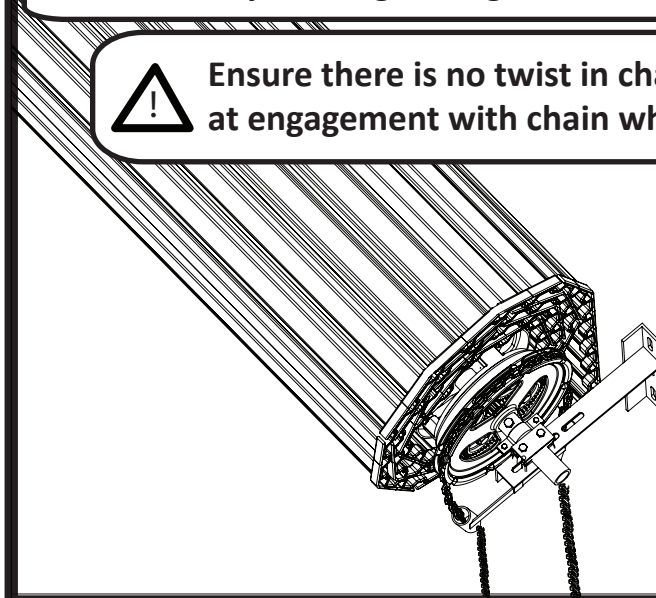

3. Centre door in opening by adjusting axle position on bracket. DO NOT ADJUST BY SHIFTING DOOR CURTAIN ON SHAFT

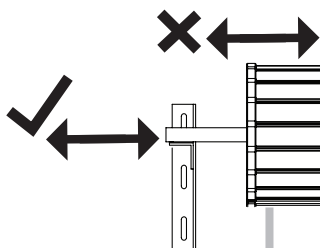

5. Tighten saddle fixings on both sides

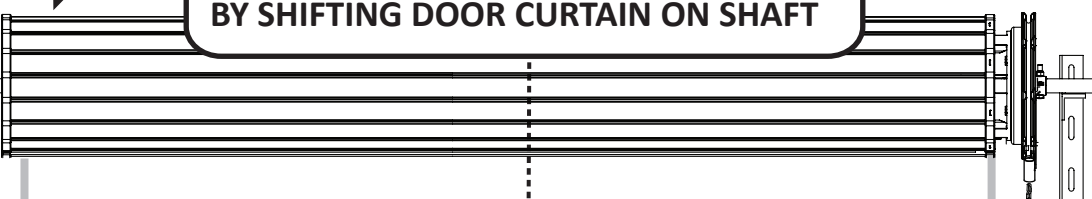

STEP 5 Apply Tension To Door

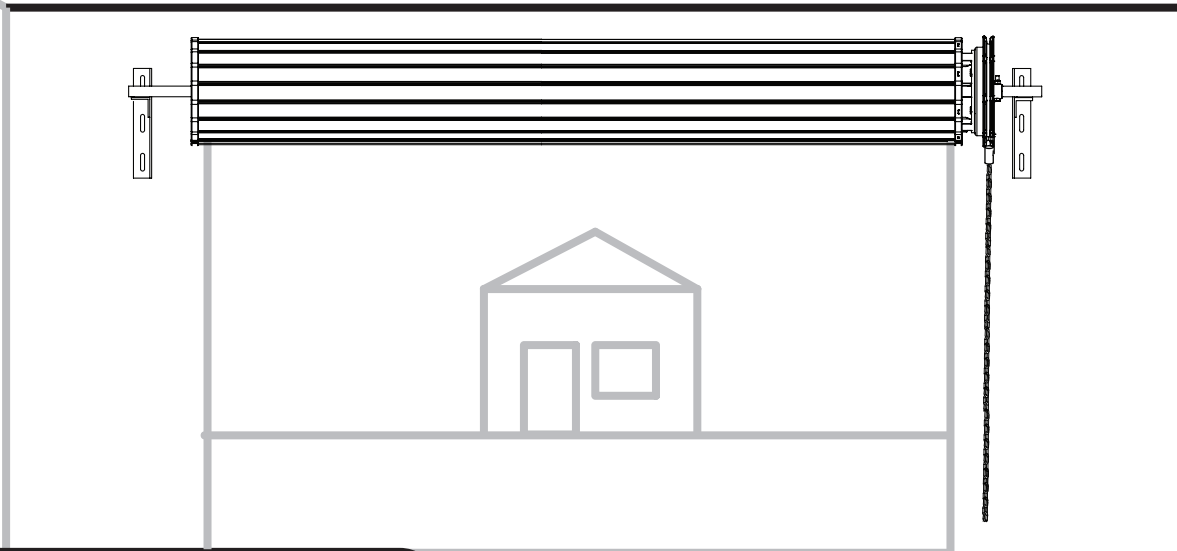

1. Pre-tension spring by rotating door assembly

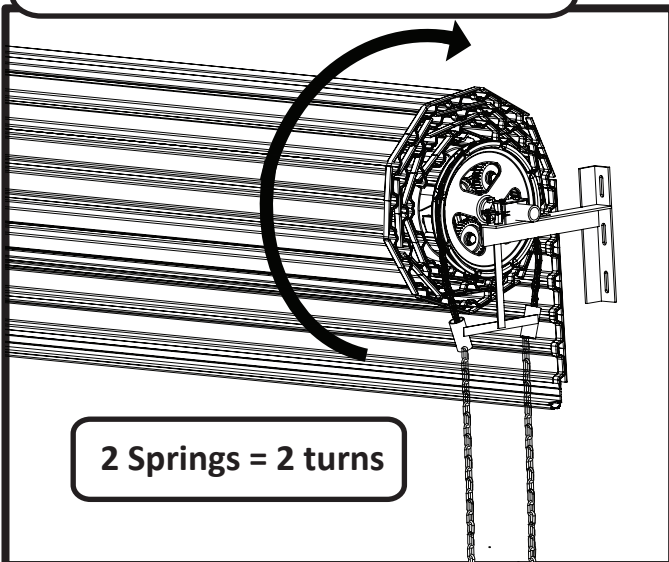

2. Hold door in position and cut away plastic wrapping

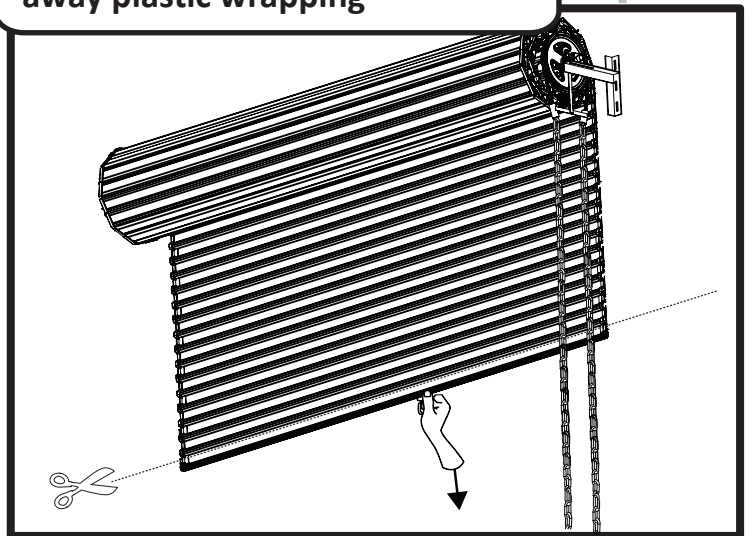

3. Pull curtain down 200-300mm and ensure door stays in this position

⚠ Use a soft wood chock to hold door in position

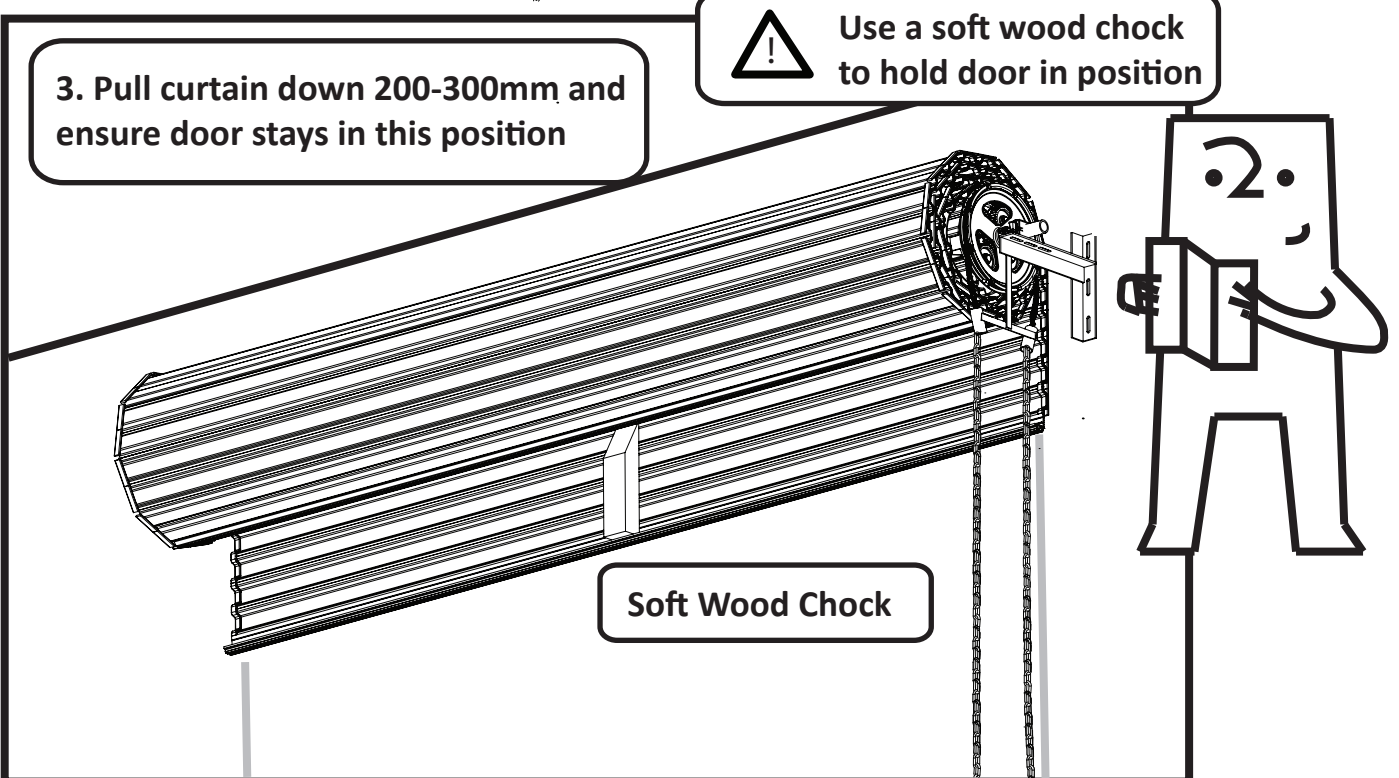

STEP 6 Install Tracks

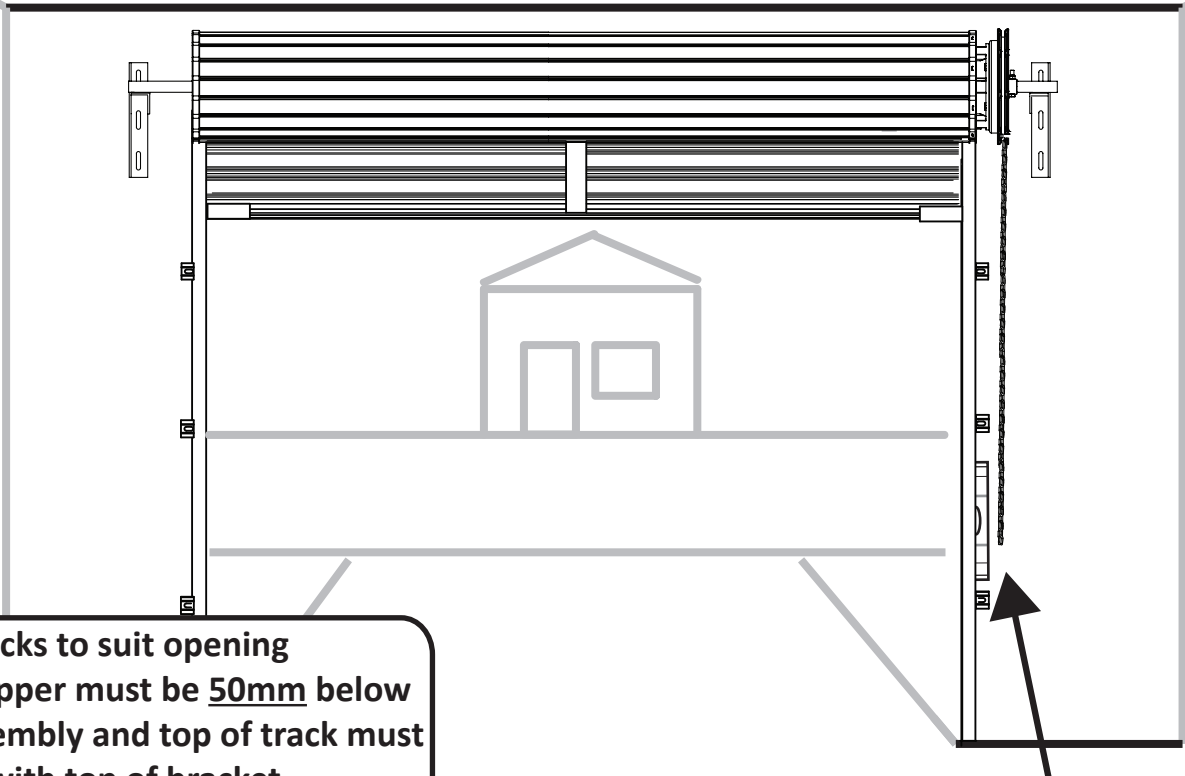

1. Cut tracks to suit opening
Track stopper must be **50mm** below door assembly and top of track must be level with top of bracket



Ensure tracks are perpendicular and plumb

2. Secure guide clips to wall using appropriate fixing.

B Series

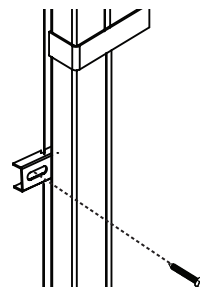

1x
M8 - 70mm Hex Screw



6x

AA Series - Guide Clips

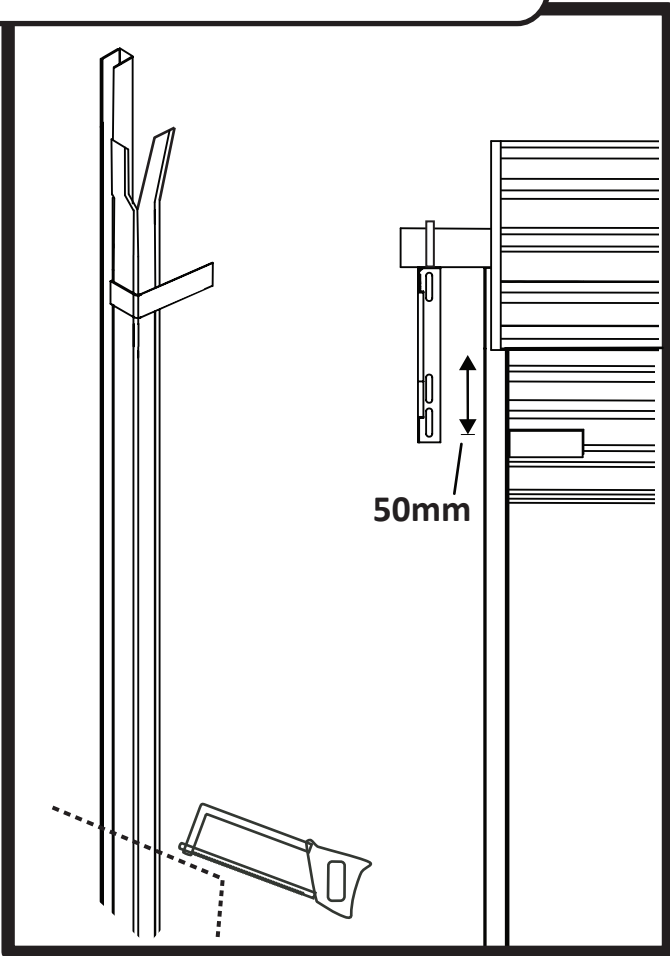

50mm

STEP 7 Check Tension and Adjust If Necessary

WARNING



This step must only be carried out by suitably trained professionals. Only adjust door when fully open

1. Roll door up door to 75% open position and ensure door stays neutral ie. does not roll up or down. Proceed to Step 2 if door fails to stay neutral

2. Gently Roll door up to track stops then loosen Saddles on one side. Apply Stilsons to axle on other side

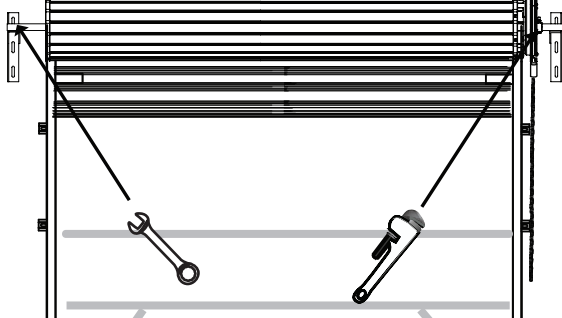

3. Slightly loosen Saddles whilst holding axle with Stilsons. Use Stilsons to increase or decrease tension

Decrease tension if door rolls up
Increase tension if door rolls down

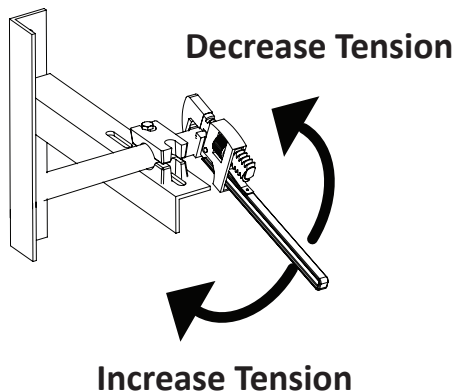

5. Fit roller door chain lock at approximately waste height

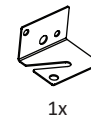
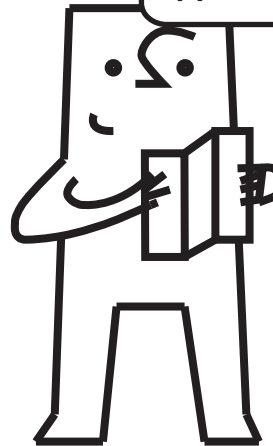

Roller Door Chain Lock

4. Tighten Saddles, remove Stilsons and tighten other Saddles on other side
Check operation of the door and re-adjust tension if necessary (Step 3)

③ Tighten Saddles on Other Side

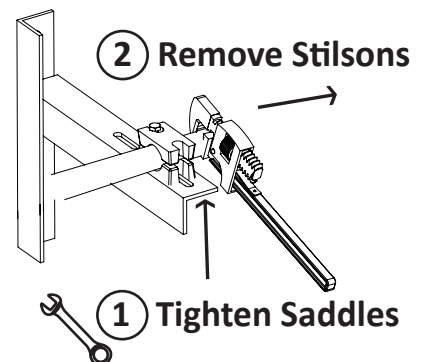

STEP 8 Drill Locking Bar Holes
Manual Operation Only

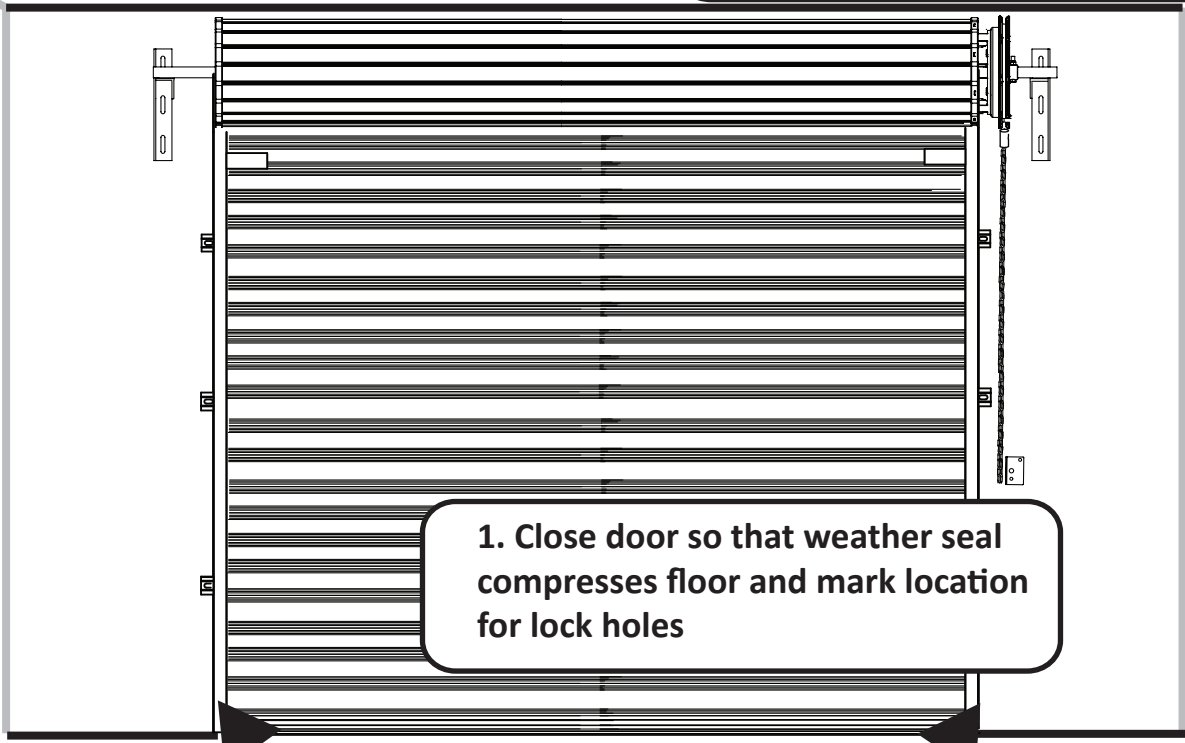

2. Drill lock holes in both tracks Note. Minimum lock hole diameter = 26mm

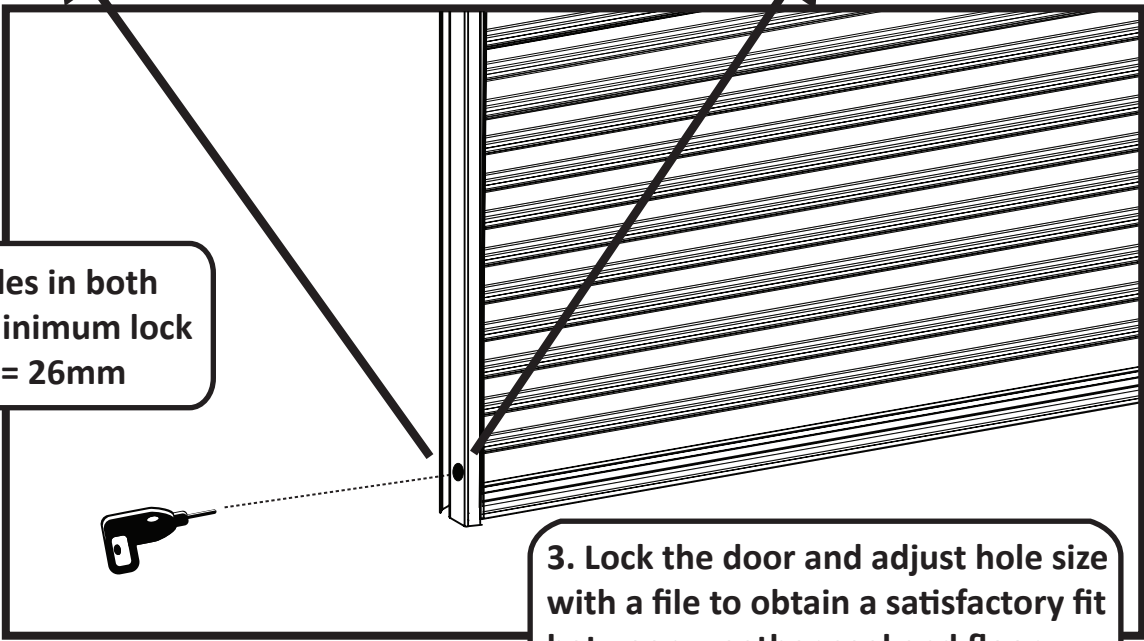

⚠ Ensure weather seal compresses floor before marking lock holes

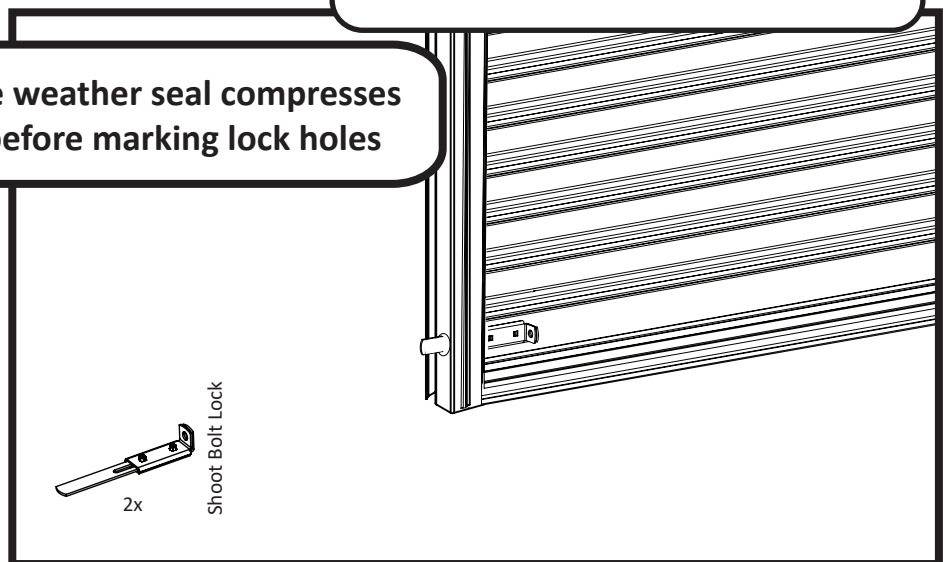

STEP 9 Peel Plastic Film Off Door

Carefully peel protective plastic wrap from door curtain



Ensure plastic wrap is completely removed before leaving site

Door Checklist



GENERAL DOOR CHECKLIST

- Spring Tension**
*Door operates smoothly when opening and closing
Add/release tension as required in Step 7*
- Guide Clearance**
*Tracks are clean and have adequate clearance
between end of curtain and guide surface*
- Bracket Setting**
Both mounting brackets are level and door rolls up evenly
- Chain Twist**
Ensure there is no twist in chain at planetary gear set engagement
- Weather Seal**
Weather seal is trimmed for length and compressed evenly against floor
- Lock Operation**
*Lock holes have been cut and door sits level,
compresses weather seal and operates smoothly*
- Clean**
*Ensure plastic wrap is removed from external face of door
Clean and touch up any scratches*