

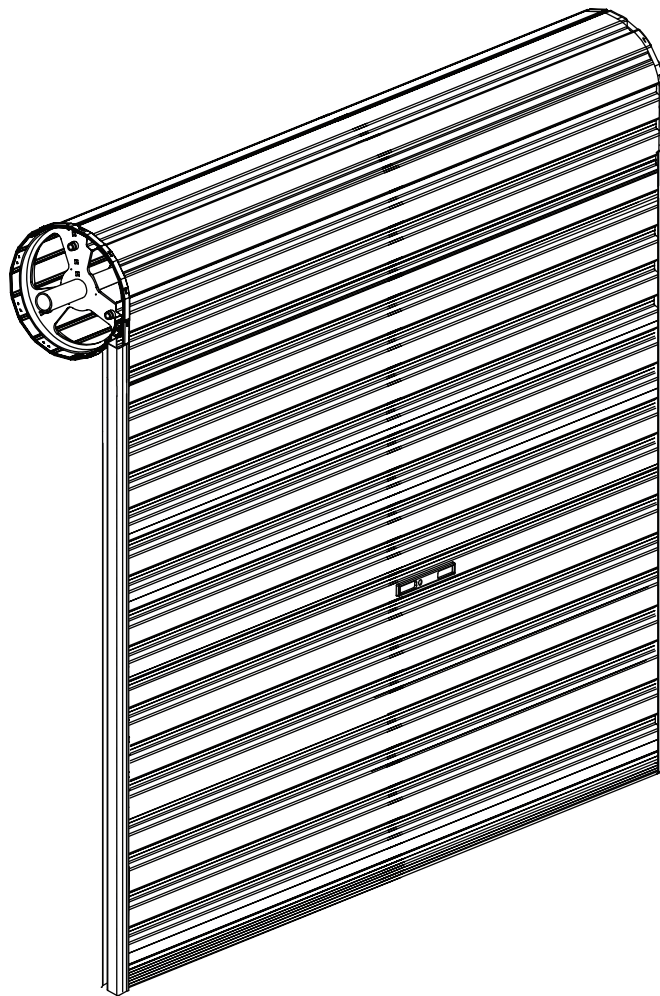

CENTURION

GARAGE DOORS®

NATIONAL



SERIES "A & AA" ROLLER DOOR

Installation Instructions

Revision D - January 2017

**This install is to only be carried out
by a suitably trained industry professional**

WWW.CGDOORS.COM.AU



**HAZARD
CONTROL**

SAFETY CHECKLIST



WARNING



Failure to install this product according to manufacturer's recommendations may result in property damage or serious personal injury. Centurion Garage Doors will not be held responsible for personal injury or product defects if the door is not installed as instructed.

SAFETY CHECKLIST

Do not install this product unless you have read and understood the following safety checklist. All items listed below must be checked and correctly implemented.

1. Prior to commencing work, complete a formal risk assessment and tidy up the work site. Ensure the work area is clear and safe!
2. Apply correct lifting technique. Do not twist when lifting heavy loads. Bend knees and ensure back is kept straight
3. Ensure all people are kept clear of installers work area with appropriate signage.
4. Wear appropriate PPE (boots, safety glasses, ear plugs, gloves, etc).
5. Keep hands clear of all sharp edges and potential pinch points.
6. Ensure that flammable liquids or materials are removed from the area of work.
7. While working at heights, ensure a ladder is used correctly and checked before usage. Do not stand on top rung.
8. Ensure all electrical connections are kept clear from liquids/moisture. Cords must be kept away from oil, heat and sharp edges.
9. Ensure door is correctly secured when applying tension.
10. Ensure stilsons are used as per instructed and hands are kept clear of the stilsons at all times.
11. Ensure people do not walk under door when door assembly is suspended onto brackets.
12. Tighten "U" Bolts adequately when fixing door assembly to brackets. Ensure not to over tighten, as saddles may distort.

Parts List

Large Components

A Series

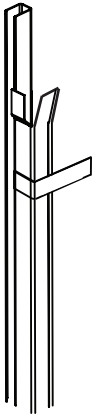

1 Pair 30mm "A" Series Guide

AA Series

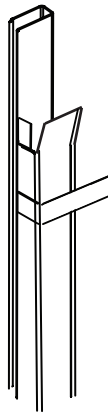

1 Pair 50mm "AA" Series Guide

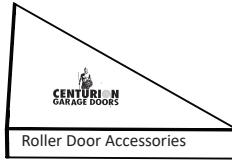

1 x Roller Door Accessory Box



1 x Assembled Roller Door

Additional Components

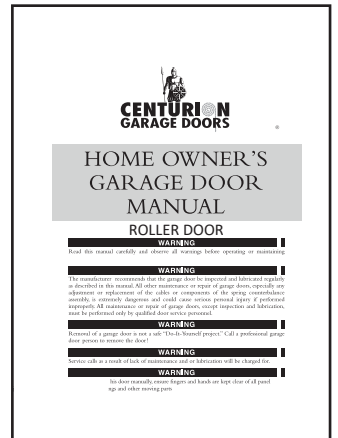

1x Roller Door Manual

Core Components

A Series

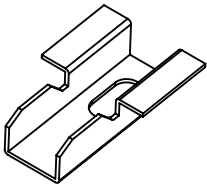

6x A Series Guide Clips
RGC08301

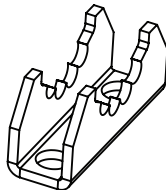

2x Pressed Saddle
RS5020-Y2

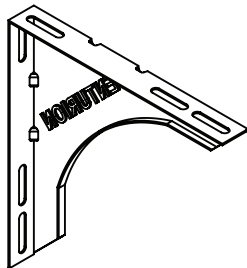

1Pair "A" Roller Door Bracket
CEN103

AA Series

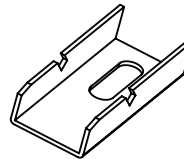

6x AA Series Guide Clips
RGC08401

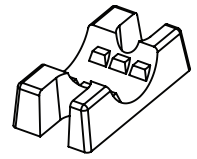

2x Cast Iron Saddle
RP001

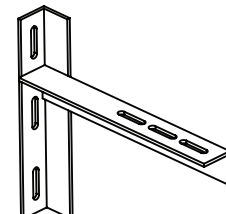

1 Pair "AA" Roller Door Bracket
CEN105/106

Fasteners

A Series

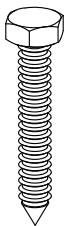

M8 - 70mm Hex Screw
12x

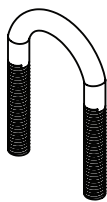

5/16 - Colour Zinc U Bolt
2x

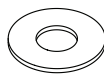

8.2mm ID - Washer
16x



5/16 - Hex Flange Nut
4x

AA Series

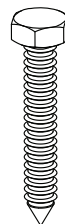

M8 - 70mm Hex Screw
12x

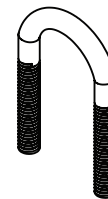

3/8 - Colour Zinc U Bolt
2x

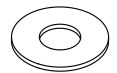

8.2mm ID - Washer
16x



3/8 - Washer
4x



3/8 - Hex Flange Nut
4x

STEP 1 Establish Horizontal Datum and Measure Opening

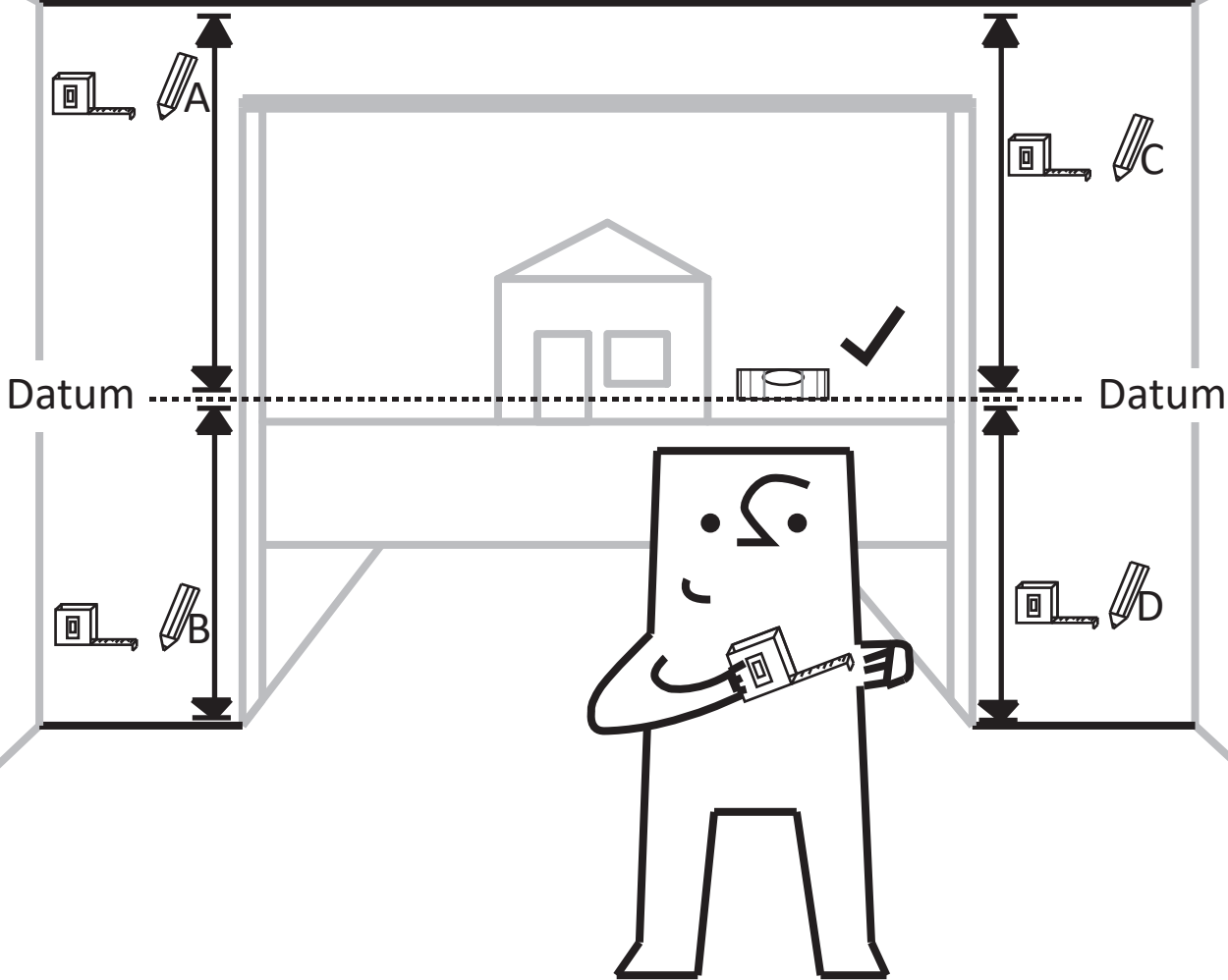

Record Measurements

LHS

Floor to Datum = B mm

Datum to Ceiling = A mm

Floor to Datum + Datum to Ceiling = A+B mm

RHS

Floor to Datum = D mm

Datum to Ceiling = C mm

Floor to Datum + Datum to Ceiling = C+D mm

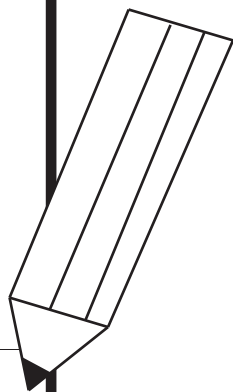

Check Door Size Is Suitable For Opening

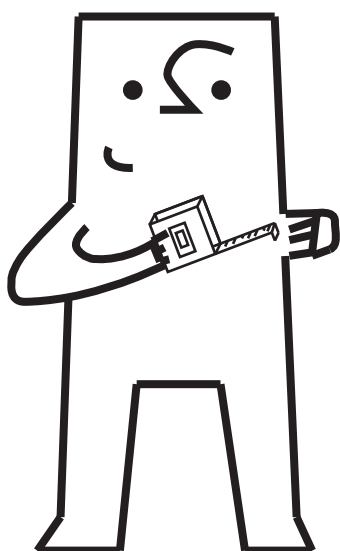
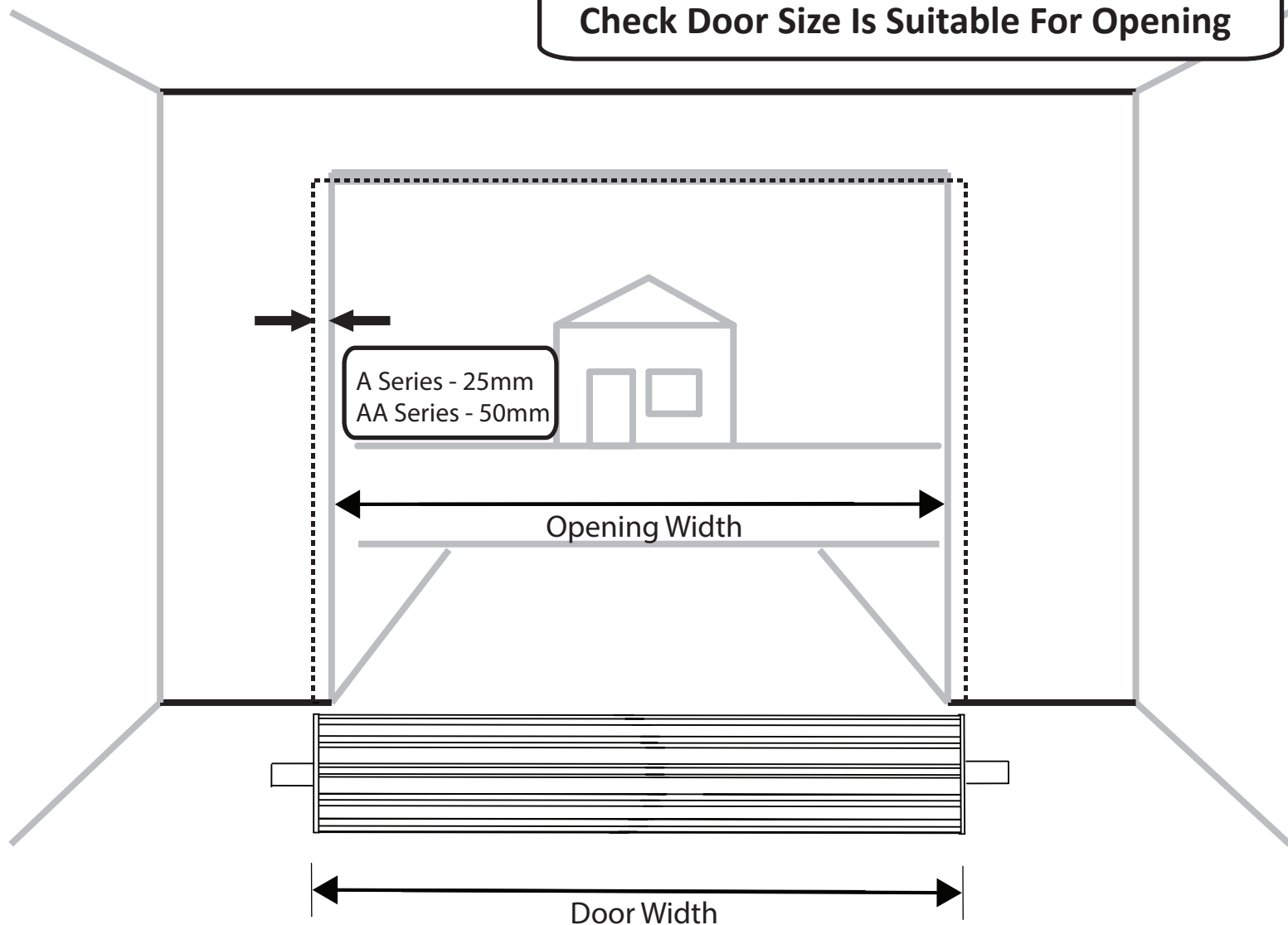

Confirm Correct Door Size

A Series

Door Width = Opening Width + 50mm

AA Series

Door Width = Opening Width + 100mm



STEP 2 Install Mounting Brackets

⚠ Ensure Brackets Are Level
Using Water Level or Laser

For A Series door use bracket A
For AA Series door use bracket B

A Series

270mm

150mm

OVERLAP + 50mm

A

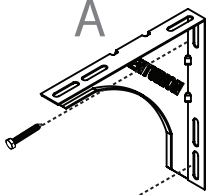

2x M8 - 70mm Hex Screw

A

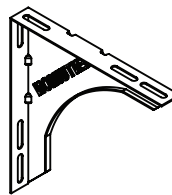

1 Pair "A" Roller Door Bracket

B

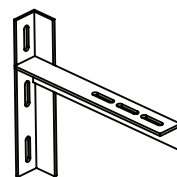

1 Pair "AA" Roller Door Bracket

Ensure top of bracket is 270mm from ceiling and 150mm from top of opening, or else opening height will be reduced.

AA Series

270mm

150mm

OVERLAP + 50mm

B

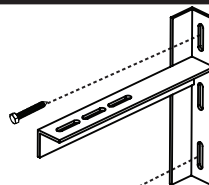

2x M8 - 70mm Hex Screw

STEP 3 Centralise Shaft And Lift Door



3. Lift Door assembly onto brackets

1. Centralise Shaft
Rotate and push shaft simultaneously

2. Wipe grease and mark shaft with paint pen on both sides to ensure shaft remains centred about the curtain

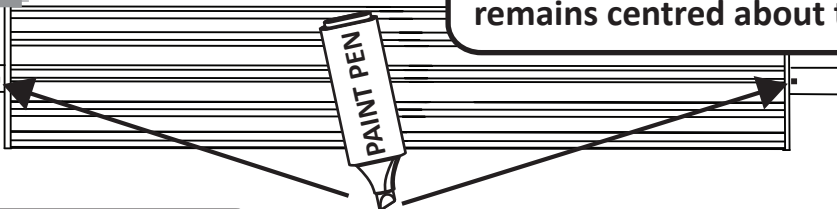

4. Place shaft onto saddles and hand tighten U Bolt

A Series

AA Series

LOOSE FIT ONLY

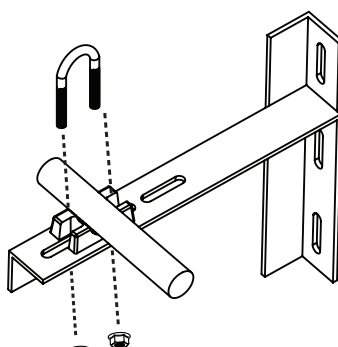
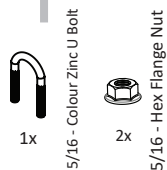
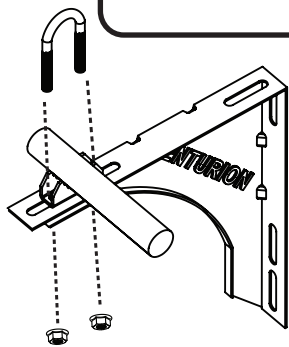

Position U-Bolt in rear slots

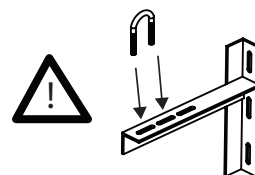

5. Centre door in opening by adjusting axle position on bracket. **DO NOT ADJUST BY SHIFTING DOOR CURTAIN ON SHAFT**

Paint Pen Mark

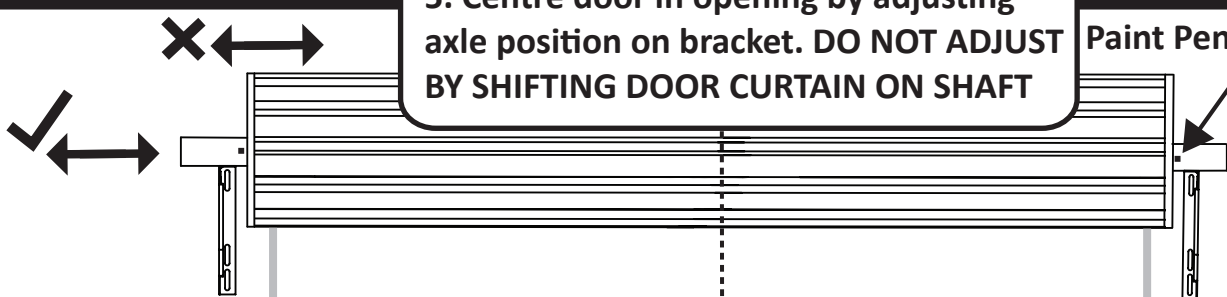

6. Tighten U Bolts on both sides



Paint pen marks must remain visible on both sides of the door

STEP 4 Apply Tension To Door

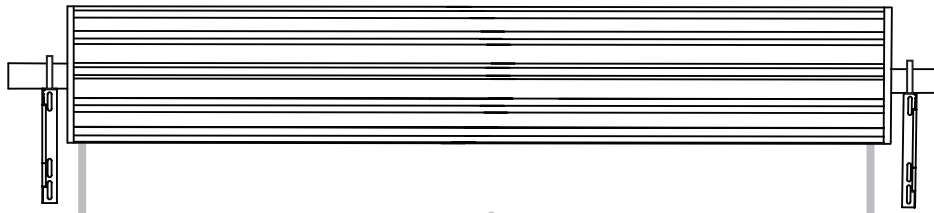

1. Pre-tension spring by rotating door assembly

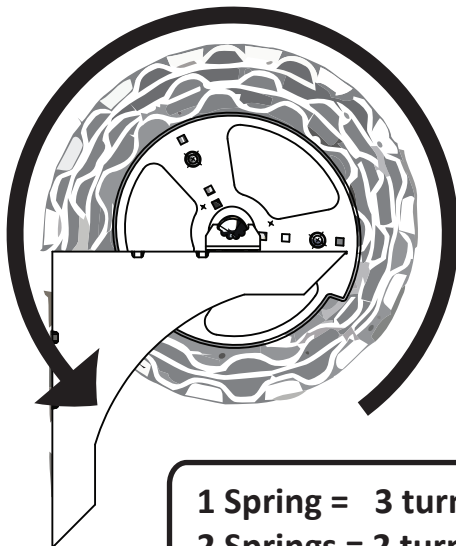

1 Spring = 3 turns
2 Springs = 2 turns

2. Hold door in position and cut away plastic wrapping

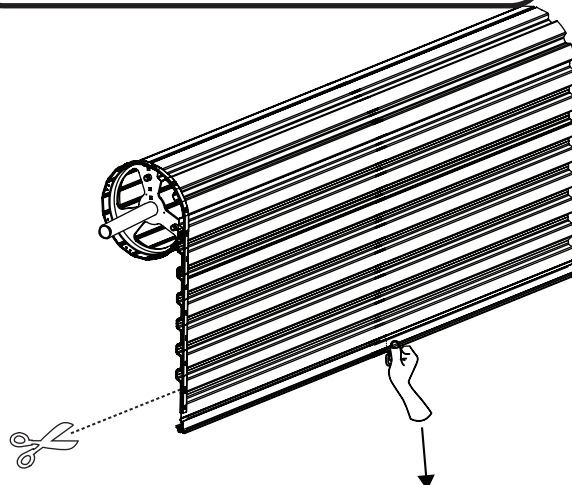

3. Pull curtain down 200-300mm and ensure door stays in this position

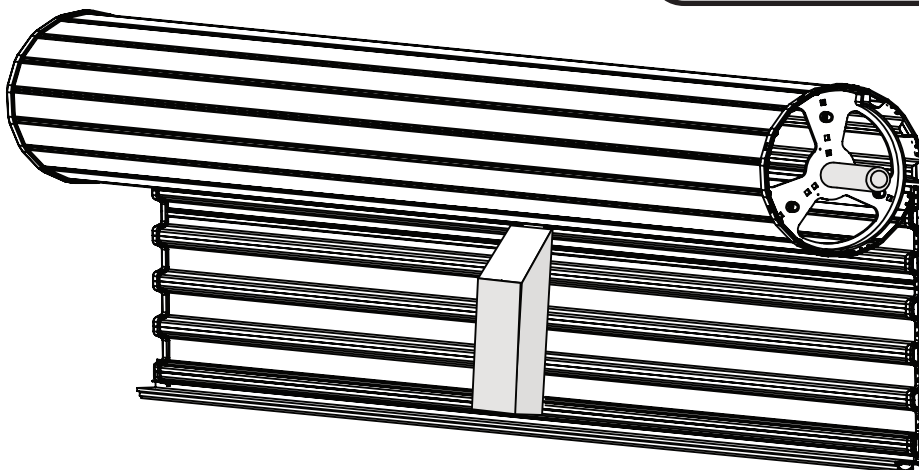

Use a soft wood chock to hold door in position

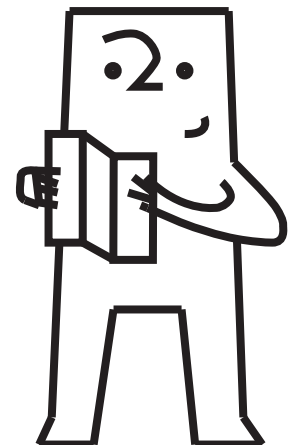

STEP 5 Install Tracks

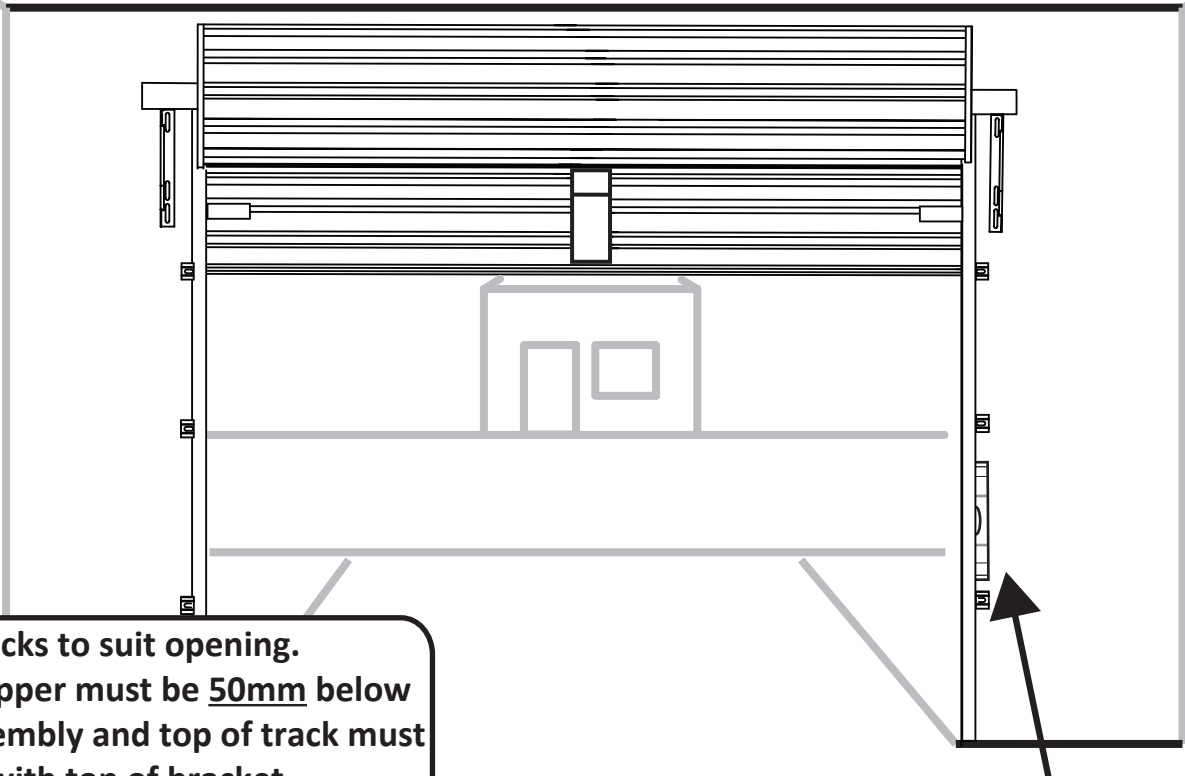

1. Cut tracks to suit opening. Track stopper must be **50mm** below door assembly and top of track must be level with top of bracket.

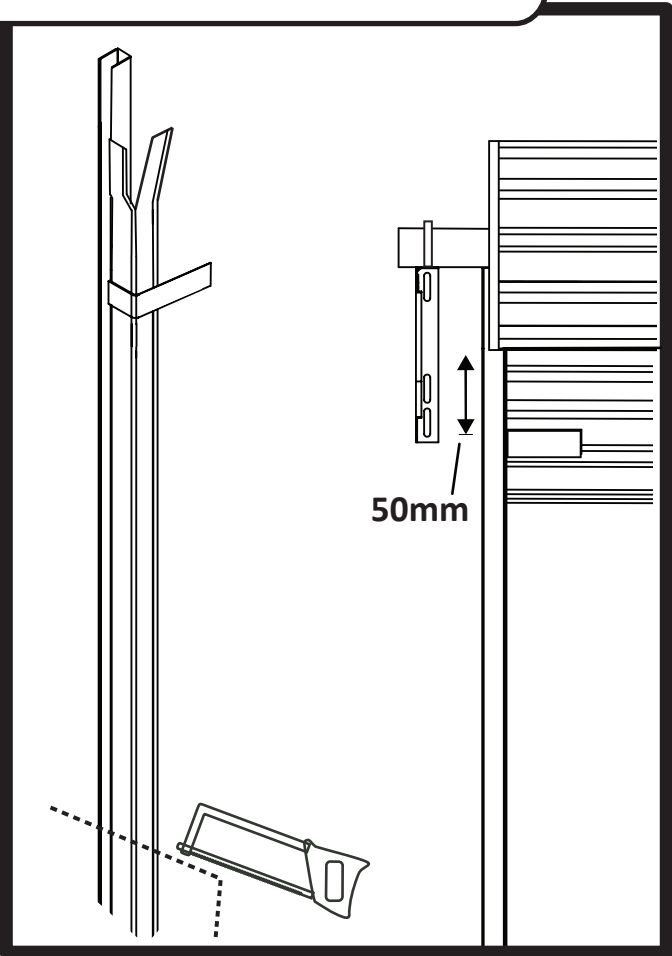

 Ensure tracks are perpendicular and plumb

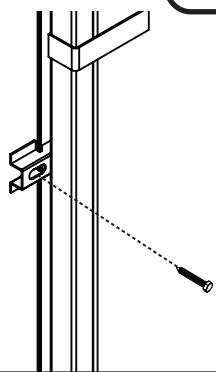

A Series

2. Secure guide clips to wall using appropriate fixing.





- 1x 
- 6x 

A Series - Guide Clips

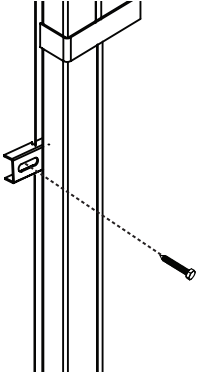
AA Series



- 1x 
- 6x 

AA Series - Guide Clips

STEP 6 Check Tension and Adjust If Necessary

WARNING



This step must only be carried out by suitably trained professionals. Only adjust door when fully open.

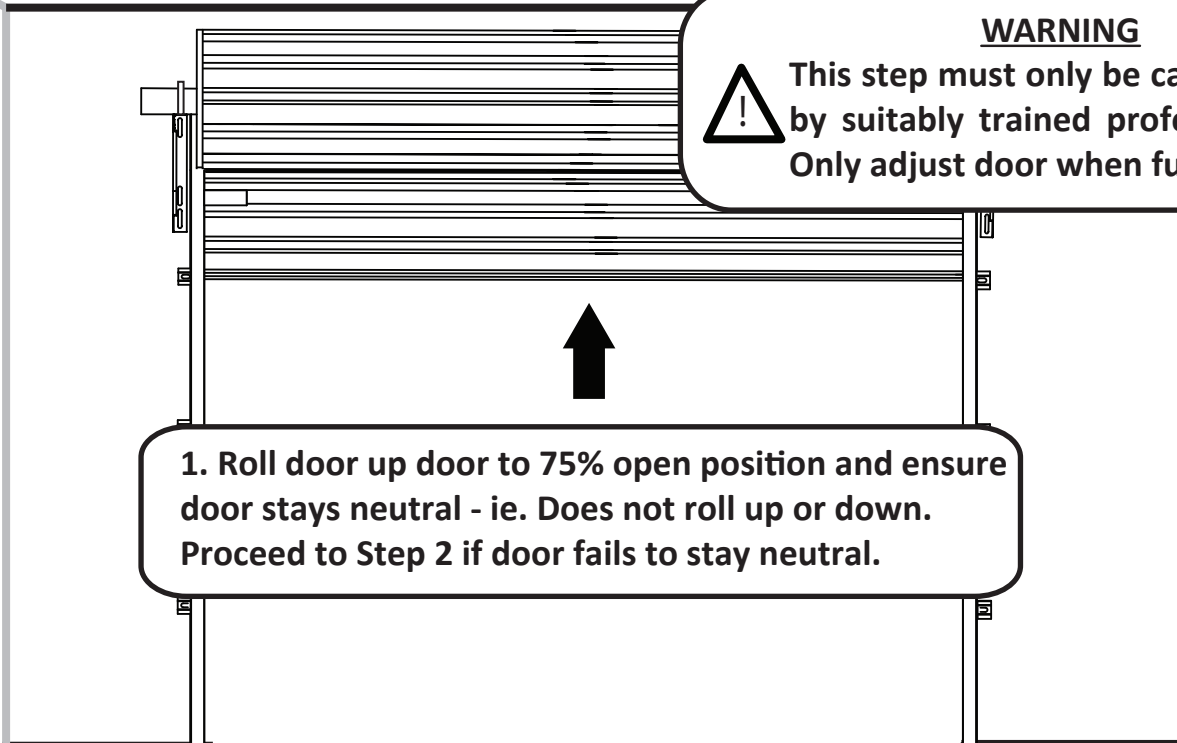

1. Roll door up door to 75% open position and ensure door stays neutral - ie. Does not roll up or down. Proceed to Step 2 if door fails to stay neutral.

2. Gently Roll door up to track stops then loosen U-Bolt on one side. Apply Stilsons to axle on other side.

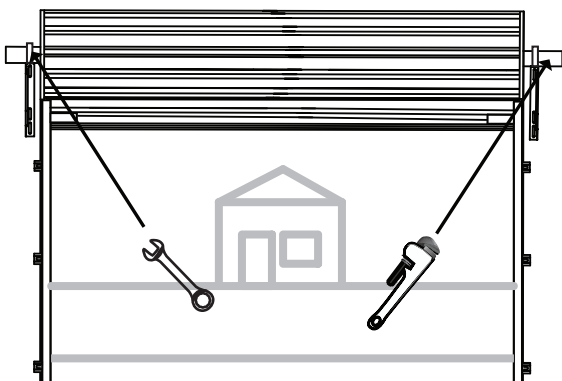

3. Slightly loosen U-Bolt whilst holding axle with Stilsons. Use Stilsons to increase or decrease tension.

Decrease Tension

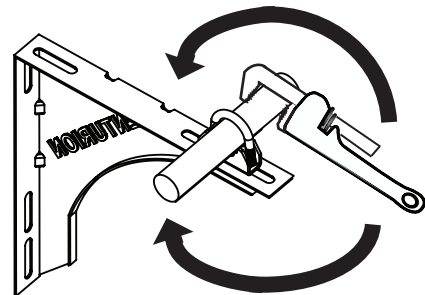

Increase Tension

3. Tighten U-Bolt, remove Stilsons and tighten other U-Bolt.

③ Tighten other U-bolt

② Remove Stilsons

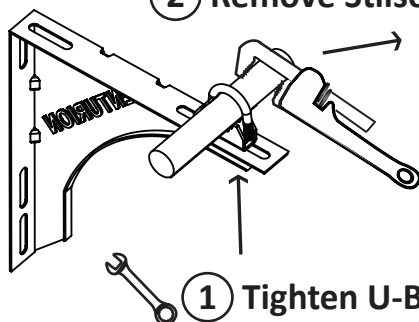

① Tighten U-Bolt

4. Check operation of the door and re-adjust tension as necessary.

Decrease tension if door rolls up
Increase tension if door falls down.

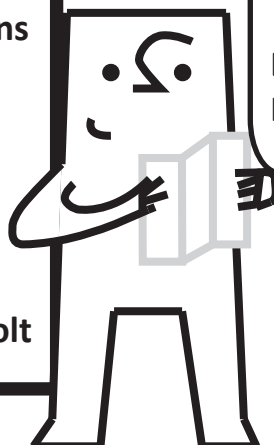

STEP 7

**Drill Locking Bar Holes
Manual Operation Only**

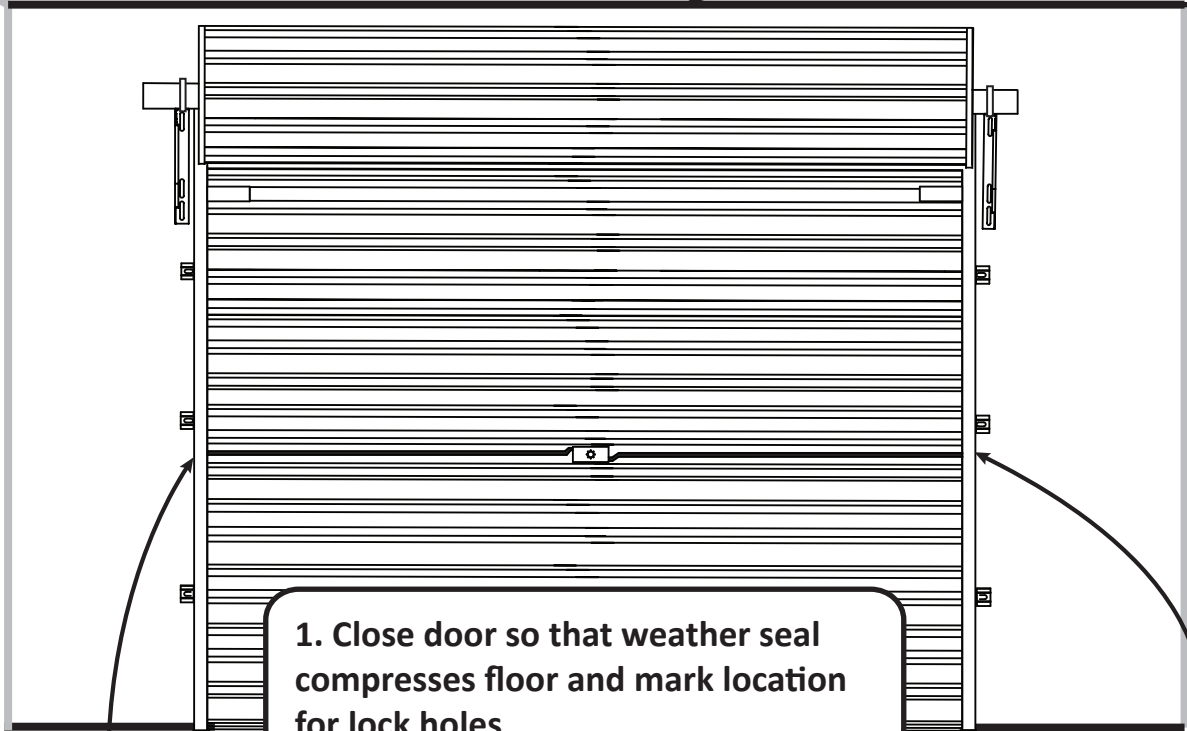

1. Close door so that weather seal compresses floor and mark location for lock holes

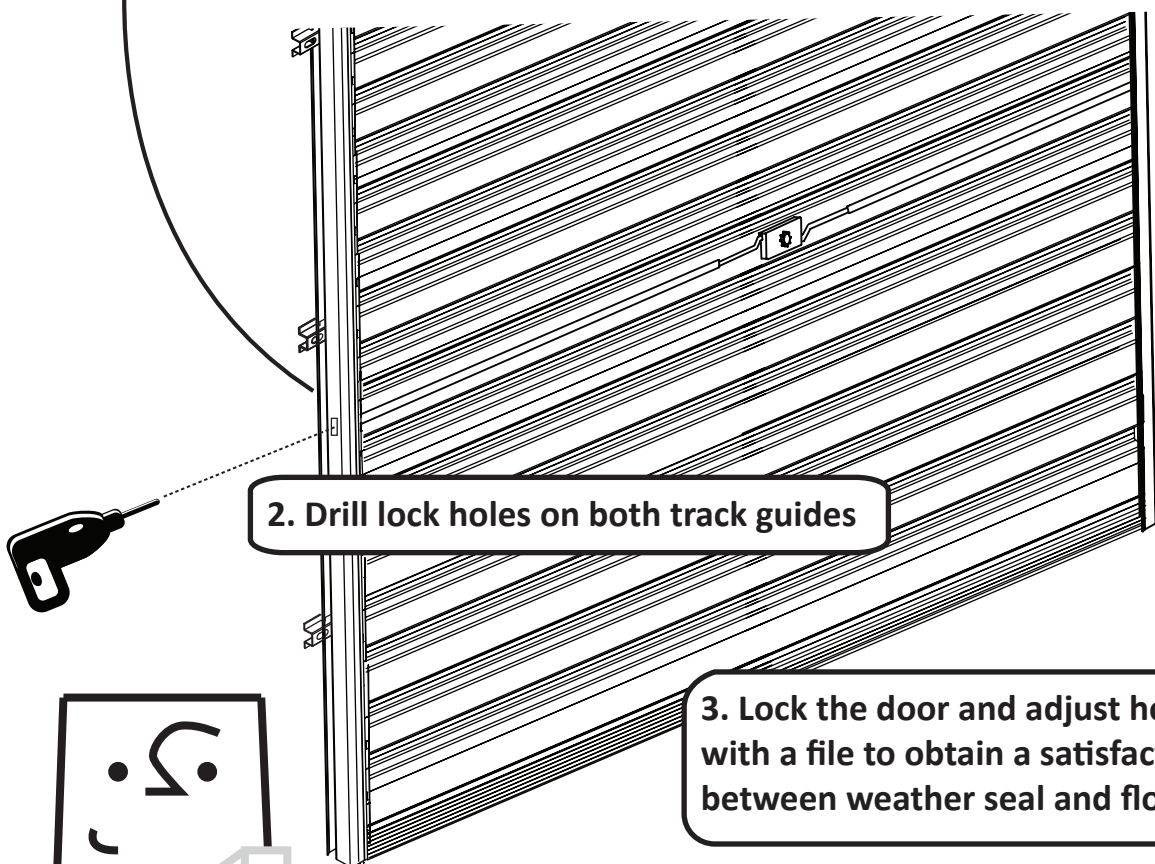

2. Drill lock holes on both track guides

3. Lock the door and adjust hole size with a file to obtain a satisfactory fit between weather seal and floor

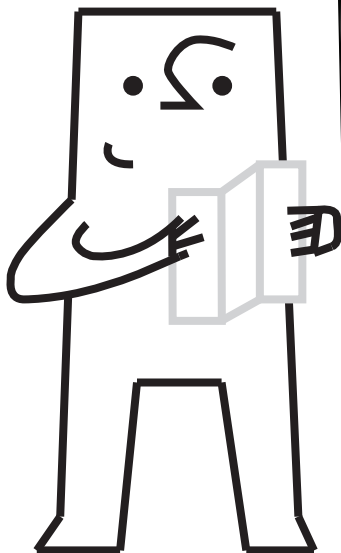

Ensure weather seal compresses floor before marking lock holes

STEP 8 Peel Plastic Film Off Door

Carefully peel protective plastic wrap from door curtain



Ensure plastic wrap is completely removed before leaving site

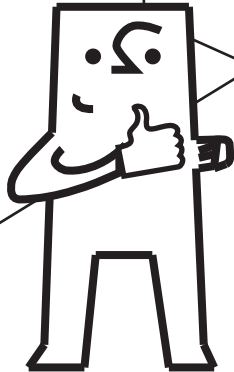

Door Checklist



GENERAL DOOR CHECKLIST

- Spring Tension**
*Door operates smoothly when opening and closing
Add/release tension as required in Step 6.*
- Guide Clearance**
*Tracks are clean and have adequate clearance
between end of curtain and guide surface.*
- Bracket Setting**
Both mounting brackets are level and door rolls up evenly.
- Weather Seal**
Weather seal is trimmed for length and compressed evenly against floor.
- Lock Operation**
*Lock holes have been cut and door sits level,
compresses weather seal and operates smoothly.*
- Clean**
*Ensure plastic wrap is removed from external face of door
Clean and touch up any scratches.*